

Candle

Sprayer W/Hose & Holder 6757-9G-81CP

INTRODUCTION:

This series has a nice cylindrical body design, which shows a balanced and symmetrical beauty. A simple shape of the handle shows the generous and tidy appearance. Overall mix was designed to create a noble and harmonious visual experience.



DESCRIPTION:

- 1.Brass of forging body meets JIS 3604 standard.
- 2.Premium metal construction for durability.
- 3.Justime finishes resist corrosion and tarnish.
- 4.Finish meets the standard of ASTM-SC2.
- 5.Coordinates with other products in Candle collection.

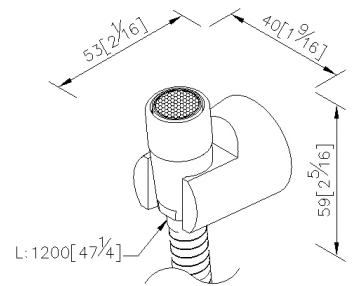

unit:mm[inch]

Certification:

Fixing Kits:

- 1.N/A

AWARD: