

Tooth Brush Holder 6804-35-80SS

INTRODUCTION:

The main base had been designed with extended cone shape, the lovely appearance display the charming flavor.



DESCRIPTION:

- 1.High Quality Brass.
- 2.Premium metal construction for durability.
- 3.Justime finishes resist corrosion and tarnish.
- 4.Finish meets the standard of ASTM-SC2.
- 5.The cone plinth of the bathroom accessories could increase the elegance for environment.
- 6.Finished: Brushed Nickel with Lacquer, which it's not easy to leave fingerprints on the surface.
- 7.Correctly installed product's loading is 2 kgf.
- 8.The special design of the tooth brush holder, not only increase the useful feature to the user but also the fashionable for the bathroom.

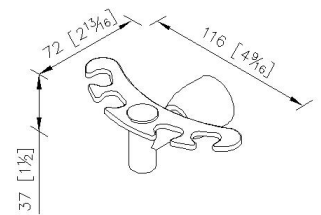

unit:mm[inch]

Certification:

Fixing Kits:

- 1.SUS 304 Stainless Steel Screws*2
- Hex Key 1/8"*1
Plastic Anchors*2
Material of Wall Mount Bracket: Copper JIS3771*1

AWARD: