

**Tooth Brush Holder**  
**6804-35-80SS**

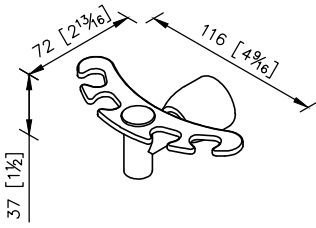

unit: mm[inch]

- 1.High Quality Brass.
- 2.Premium metal construction for durability.
- 3.Justime finishes resist corrosion and tarnish.
- 4.Finish meets the standard of ASTM-SC2.
- 5.The cone plinth of the bathroom accessories could increase the elegance for environment.
- 6.Finished: Brushed Nickel with Lacquer, which it's not easy to leave fingerprints on the surface.
- 7.Correctly installed product's loading is 2 kgf.
- 8.The specail design of the tooth brush holder, not only increase the useful feature to the user but also the fashionable for the bathroom.

