

Robe Hook 6880-50-80CP

INTRODUCTION:

Cylinder is widely applied to both oriental and western architectures as columns, so people would have an impression of great reliability on the cylindrical objects. Inserting this concept into our products, we have created elegant bathroom brasswares that are highly durable. This unique robe hook performs well both on decorative effect and functionality, improving living convenience.

DESCRIPTION:

- 1.Brass hook meets JIS 3604 standard.
- 2.Brass forging bracket meets JIS 3771 standard.
- 3.Premium metal construction for durability.
- 4.Justime finishes resist corrosion and tarnish.
- 5.Chrome plated finish meets the standard of ASTM-SC2.
- 6.Vertical force could support a static load of 5 Kgf.
- 7.Coordinates with other products in 6880 collection.

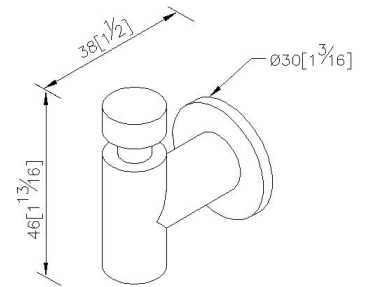

unit: mm[inch]

Certification:

Fixing Kits:

- Plastic Anchors*1
- SUS 304 Stainless Steel Screws*1

AWARD: