

Mark 1

Shower Holder 6909-9C-80CP

INTRODUCTION:

Designed main body style as square shape, the aesthetics of symmetry exudes a stylish and charming atmosphere. With R angle processed, it softens the sharp angle of hard steel, and brings soft and elegant atmosphere to a bathroom space.



DESCRIPTION:

- 1.Brass of main body meets the standard of JIS 3604.
- 2.There is a plastic insert inside the bracket for holding the hand shower stably.
- 3.Justime finishes resist corrosion and tarnish.
- 4.Chrome plated finish meets the standard of ASTM-SC2.
- 5.Coordinates with other products in 6909 collection.

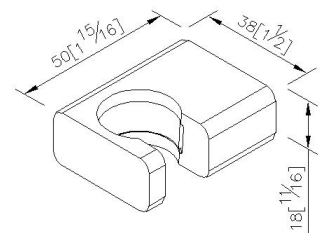

unit: mm[inch]

Certification:

Fixing Kits:

- 1.SUS 304 Stainless Steel Screws*2
- Hex Key 2.0mm*1
Plastic Anchors*2
Material of Wall Mount Bracket: Copper JIS3771*1

AWARD: