

**Basin Faucet**  
**7904-90-80CP**

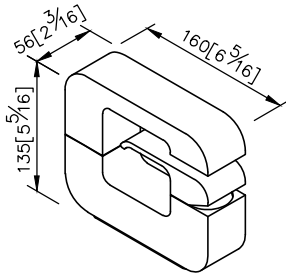

unit: mm[inch]

- 1.Brass material of faucet body meets ISO CuZn40Pb Standard.
- 2.Brass material of forging handle meets JIS 3771 Standard.
- 3.Chrome plated finish meets the standard of ASTM-SC2.
- 4.Ceramic valve with KOREA ceramic disc.
- 5.Swiveling spout has passed up to 50,000 turns test.
- 6.Stainless steel braided hose with M10 x 1.0mm Male thread (connects to faucet body) and 1/2"-14NPSM Female thread (connects to water supply system).
- 7.Stainless steel braided hose with SANTOPRENE tube (meets NSF approval), can bear 15Kg/cm2 water pressure and 120°C heat.
- 8.Aerator with removable flow regulator (2.2 GPM max.), end-user can take it off for larger water flow if necessary.

